



## ASSOCIATED HOBBY MANUFACTURERS, INC.

(A Subsidiary of General  
Hobbies Corp.)

5011 B GENERAL ELECTRIC  
5011 C UNION PACIFIC  
5011 D SANTA FE  
5011 E BURLINGTON NORTHERN  
5011 F SOO  
5011 G MILWAUKEE  
5011 H CONRAIL

SPARE COUPLER INCLUDED FREE FOR YOUR CONVENIENCE

## "G-E" Center Cab Industrial Diesel

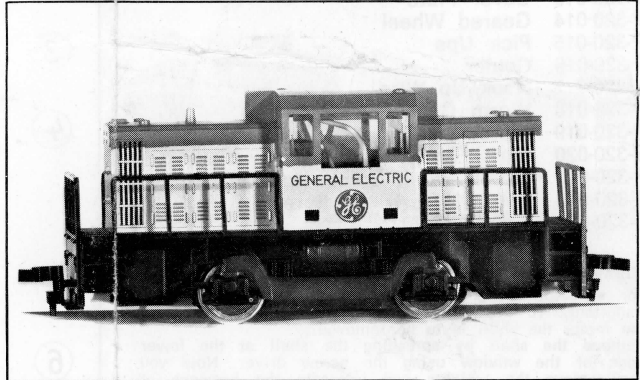

Although of industrial size, these models are real workhorses, and one should not allow their small size to mislead when it comes to what they can do. Not only are they powerful little brutes, but their wheelbase arrangement permits them to get into many a tight corner and out again. The prototypes are used not only in industrial service (many being owned by private plants) but they are also the mainstay for many a small railroad whose sharp curves and lightweight rails make the use of bigger and heavier designs out of the question.

### GUARANTEE

AHM locomotives are guaranteed against all factory defects in material or in workmanship for one year from the date of purchase. All locomotives have been thoroughly tested. AHM's guarantee will be void if the locomotive has been subject to misuse or accident, or if a repair or alteration has been made by other than an AHM Parts Depot, or by the AHM factory.

AHM's guarantee does not apply to electric light bulbs used in headlights, or to finishes on the locomotives, except where defects can be proven to have occurred at the time of manufacture. If you live in an area where no local AHM Parts Depot exists, you may return any defective unit to the factory. Be sure to mail the guaranteed registration card directly to the factory immediately.

diately. AHM's guarantee is void if it is not on file at the factory.

### SERVICE AND REPAIR NOT COVERED BY GUARANTEE

If you live in an area where no AHM Parts Depot exists, and you wish to have the unit or units repaired at the factory, be sure to carefully pack the unit, and include a money order or check for \$2.50 to cover minimum factory service and handling charges. The \$2.50 will cover all minor repairs, any necessary adjustments, the repacking and return postage to you. If major repairs must be undertaken and the cost of same, or parts, exceeds the \$2.50, you will be notified of the difference prior to the work being undertaken by the factory.

### MANUFACTURER'S REGISTRATION RECORD

Complete the information requested below. Mail to factory at once to validate guarantee. The guarantee is VOID if this card is not on file at factory, or if it does not correspond in dates etc. with trade registration.

Stock Number	-----
Name of item	-----
Street	-----
City	-----
Date Purchased	-----
Dealer's Name	-----
Street	-----
City	-----

## CENTER CAB PARTS LIST

P-320-001	Body Shell
P-320-002	Window Insert
P-320-003	Light Bulb
P-320-004	From Weight
P-320-005	Underframe Outer
P-320-006	Motor
P-320-007	Motor Holder
P-320-008	Side Cover Gear Box Cover
P-320-009	Double Gear
P-320-010	Single Gear
P-320-011	Underframe Inter
P-320-012	Wheel on Axle
P-320-013	Cover Plate
P-320-014	Geared Wheel
P-320-015	Pick Ups
P-320-016	Couler
P-320-017	Hook Up Wire
P-320-018	Worm Gear
P-320-019	Motor Brush
P-320-020	Motor Brush Spring
P-320-021	Motor Brush Sping Holder
P-320-022	Outer Underframe Screw
P-320-023	Rear Weight

### LUBRICATION

For efficient economical operation, proper lubrication is important. To lubricate axles, gears, and bearings of the motor the shell is to be removed.

Remove the shell by spreading the shell at the lower edge of the window using the screw driver. Now you can remove the weights and lubricate the bearings of the motor, worm and gears. To lubricate the gears and bearings of the wheels remove the cover plate from the chassis.

When finished, replace the cover plate paying attention to fit wheels and the contacts to the right position.

After lubrication (to lubricate use light clock oil only) replace the weights and the shell. Lubricate your locomotive once a week if run many hours, once a month if run moderately, and if run only on occasion, it is advisable to lubricate before each running.

### HOW TO SERVICE ELECTRIC MOTOR

Remove body from the chassis. Take out the weight and remove the electrical contacts from motor. This will completely separate the motor from the chassis of the locomotive. The motor can now be serviced.

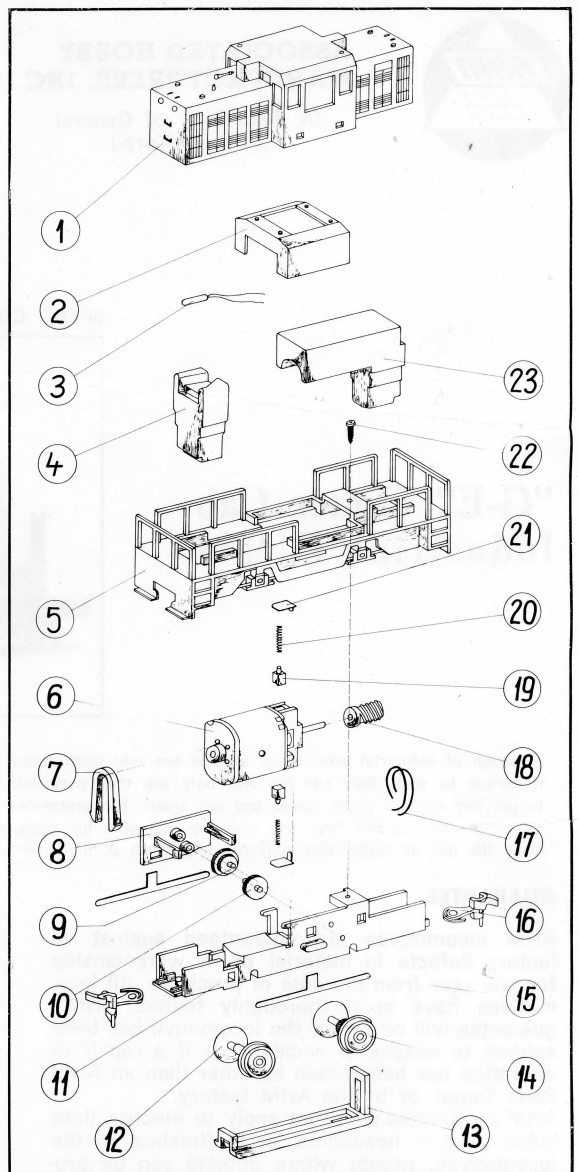

DO NOT REMOVE WORM GEAR UNLESS NECESSARY

### ELECTRICAL DATA

Maximum Absorption — 0,30 Ampere  
Maximum Voltage — 12 V DC

### CAUTION

If it is necessary to overhaul or to replace any parts contact your local AHM Parts Depot.